

Product specification

Model: UTX920B

File No:

Version: V1.0

Date	Version	Change history	Author	Approve
2017.06.27	V1.0		Ray He	

Best for 4cm+ Depth Light Box



UTX920B

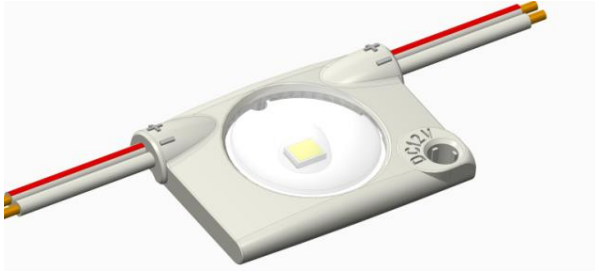

1. Features

- ✧ Constant Current Technology, 30pcs per series
- ✧ Injection molding process, water proof: IP 67
- ✧ High efficiency chip, high brightness and reliability
- ✧ Energy saving, environment friendly
- ✧ Long life span

2. Applications

- ✧ Commercial standing lighting
- ✧ Light box lighting

3. Dimensions

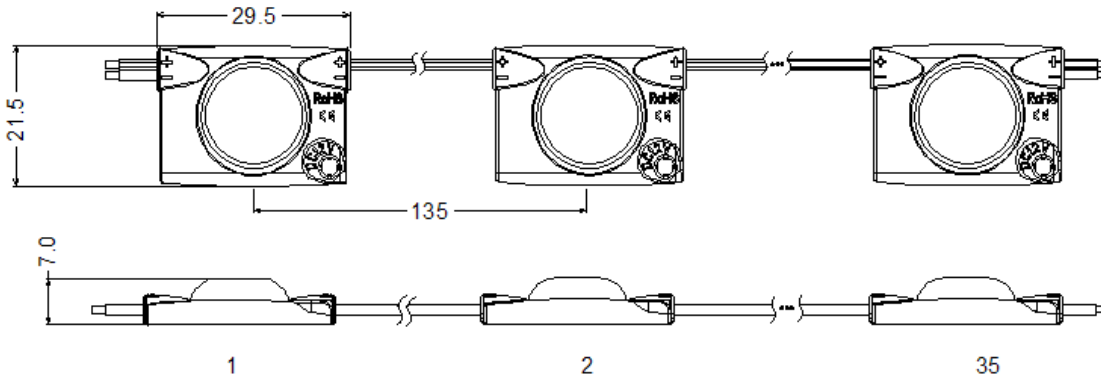

based on: L100mm wire
 unit:mm

4. Environmental and Application Conditions

Ambient temperature range (TA on free air)	-25...+55 °C
Storage temperature range	-40...+65 °C
IP rating	IP67

5. Electrical parameters

LED	9V2835
Supply voltage range (rated)	12 VDC
Supply Current range (per module)	80mA ± 10% @ DC12V
Power range (per module, rated)	0.96W ± 10% @ DC12V

6. Optical parameters (module base)

Part No.	Color Temperature		Flux Range		Beam angle
	Typ. CCT or wavelength	Max. CCT or wavelength	Min. Lumen	Typ. Lumen	
UTM920B	3000K	3200 K	85	90	170°
UTN920B	4000 K	4500 K	90	95	170°
UTW920B	6500 K	7000 K	90	95	170°

7. Light distribution graph

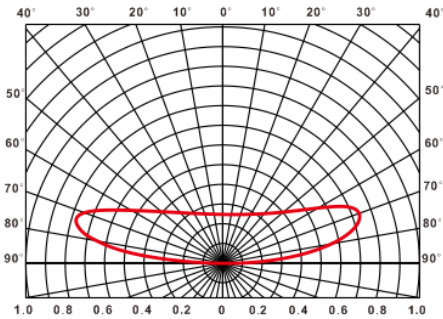

8. Attention

- Maximum number of modules of one chain is 30pcs from power supplier to single end.
- The given Illuminance parameters ensure Illuminance on the surface. Depending on the type of material used for channel letters or lighting boxed, the parameters can change. More brightness is obtained if distances between LED modules are reduced.
- The LED module itself and all its components may not be mechanical stressed.
- Please ensure that the power supply is adequate power to operate the total load. Only qualified personnel should be allowed to perform installations.
- The design of the housing should be according to the IP standards in the application.
- If surge protection structure not within power supplier, a lightning protector should be needed additionally.